



Tower Road Melksham SN12 7JQ

- No onward chain
- Three spacious bedrooms
- Enclosed rear garden
- Viewing recommended
- In need of modernisation
- Garage and parking
- Close to local amenities

£210,000 Freehold



Porch

Windows to side and front elevation, internal front door to living room.

Lounge/Dining Room

23'1" x 19'1"

Window to front elevation, patio door leading to rear garden, stairs to first floor and door to kitchen.

Kitchen

11'3" x 9'9"

Fitted with a matching range of base and eye level units with worktop space over, 1+1/2 bowl sink with mixer tap, space for fridge/freezer, washing machine and cooker, window to rear elevation, door to garden, storage cupboard.



Bedroom One

11'3" x 11'9"

Window to rear elevation.



Bedroom Two

11'7" x 10'6"

Window to front elevation.

Bedroom Three

8'5" x 8'4"

Window to front elevation, storage cupboard.

Bathroom

5'7" x 7'1"

Three piece suite comprising wash hand basin, shower enclosure and WC, window to rear elevation.

Landing

Storage cupboard, doors leading to bedrooms and bathroom.

Garage

Up and over door, window to rear.

Outside

Enclosed rear garden, garage with parking space in front.



Local Authority **Wiltshire**
Council Tax Band **B**
EPC Rating **D**

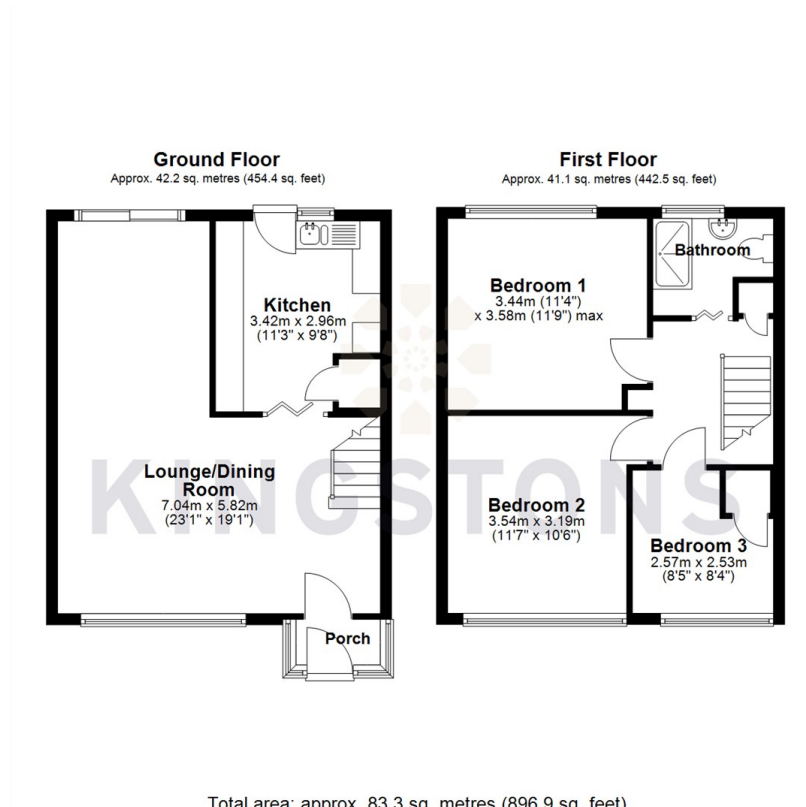

KINGSTONS

Melksham Office

11 High Street, Melksham,
Wiltshire, SN12 6JR

Contact

01225709115
sales@kingstons.biz
www.kingstons.biz

Agents Note: Whilst every care has been taken to prepare these particulars, they are for guidance purposes only. All measurements are approximate and for general guidance purposes only and whilst every care has been taken to ensure accuracy, they should not be relied upon and potential buyers/tenants are advised to recheck the measurements.